



CinMay Visa Services LLC – School Profile
SUNY – Oswego (www.oswego.edu)
7060 State Route 104, Oswego, NY 13126

SUNY – Oswego



Last Updated: September 1, 2006

Website: <http://www.oswego.edu>

School Address:

7060 State Route 104
Oswego, NY 13126

Phone: +1 315-312-2500

U.S. News Ranking: Universities – Master's (North), Third Tier

School Type: Public
Year Founded: 1861

Undergraduate Students: 7,100
Total international students: 65 (1%)

Application deadline: Rolling

TOEFL may be submitted in place of SAT or ACT: Yes

Minimum TOEFL score required: 550 (paper), 213 (computer)

Average TOEFL score: 550 (paper)

Tuition and Fees: \$5,222 in-state, \$11,482 out-of-state

Room and Board: \$8,340

Undergraduate Programs

- Accounting BS, MS
- Applied Mathematics BS
- Applied Mathematical Economics BS

- Biology BA, BS
- Biochemistry BS

- Business Administration BS, MBA
- Business and Marketing Education (All Grades) BS, MEd

- Chemistry BA, BS, MS
- Communication Studies BA
- Computer Science BA, BS
- Economics BA
- Finance BS
- Geochemistry BS
- Geology BA, BS
- Global and International Studies BA
- Graphic Design BFA

- History BA, MA
- Human-Computer Interaction MA
- Human Development BA
- Human Resource Management BS
- Human Services/Community Counseling MS
- Information Science BA
- Journalism BA
- Language and International Trade BA

- Management Accounting BS
- Management Science BS
- Marketing BS
- Mathematical Economics, Applied BS
- Mathematics BA
- Meteorology BS

- Philosophy BA
- Philosophy-Psychology BA
- Physics BA, BS
- Political Science BA
- Psychology BA
- Pre-law emphasis
- Pre-med emphasis
- Public Accounting BS, BS/MBA (combined degree program)
- Public Justice BA
- Public Relations BA

- School Psychology CAS, MS
- Sociology BA
- Technology Management BS
- TESOL (Teaching English to Speakers of Other Languages, All Grades) BS
- Vocational Technical Education MEd
- Wellness Management BS
- Women's Studies BA
- Zoology BA, BS



Cooperative Degree Programs

- **Cardiovascular Perfusion** 2+2 BS from SUNY Upstate Medical University
- **Cytotechnology** 2+2 BS from SUNY Upstate Medical University
- **Engineering** 3+2 BS in Chemistry or Physics from Oswego and a BS in engineering from Case Western Reserve University, SUNY Binghamton or Clarkson University
- **Medical Imaging Sciences** 2+2 BS from SUNY Upstate Medical University
- **Medical Technology** 2+2 BS from SUNY Upstate Medical University
- **Physical Therapy** 3+3 BS/DPS from SUNY Upstate Medical University
- **Pre-Optometry** 3+4 BA in Chemistry from Oswego and an OD in Optometry SUNY College of Optometry, New York City
- **Radiation Therapy** 2+2 BS from SUNY Upstate Medical University
- **Respiratory Care** 2+2 BS from SUNY Upstate Medical University
- **Zoo Technology** 3+2 BS in Zoology from Oswego and an AS in Zoo Technology from Sante Fe Community College, Florida

Graduate Programs

College of Arts and Science

- Master of Arts, Major in Art
- Master of Science, Major in Chemistry
- Master of Arts, Major in History
- Human Computer Interaction, Interdisciplinary Master's Program

School of Business

- Five-year combined BS/MBA in Accounting
- Master of Business Administration (MBA)

School of Education

- Counseling and Psychological Services
- Curriculum and Instruction
- Educational Administration
- Technology
- Vocational Teacher Preparation

Admission Requirements for International Students

- Documented, strong academic work, received on an official transcript from all appropriate and prior schools.
- Documented adequate financial support, readily accessible within the USA.
- Documented English language abilities. [This may include national language, mother tongue,

language of prior degree or secondary school study, or appropriate IELTS or TOEFL scores. For further information see English for Academic Purposes. SUNY Oswego's TOEFL code is 2543.

If English is not your documented mother tongue, or documented language of academic instruction, a TOEFL score of 550PBT/213CBT or an IELTS score of 6.0 or documentation of appropriate English language competency is required.

English for Academic Purposes Program

Program Description: The English for Academic Purposes program is specifically designed for ESL undergraduate and graduate students as well as exchange students to improve and develop their academic English language proficiency. Each course is a three-credit course and each course counts towards graduation.

Undergraduate Degree Requirements: For undergraduate degree programs, students require minimum TOEFL scores of 213 on the Computer Based Test, or 6.5 on the IELTS to register for courses in fall or spring semester.

Students with TOEFL scores between 173-210 or IELTS bands from 5.0-6.0 will be registered into credit courses in the Summer Intensive English Program to improve and develop their academic English language skills. In the fall semester, students with TOEFL scores below 213 or IELTS below 6.5 will be registered into four English for Academic Purposes courses that count towards graduation.

MBA Program: Students interested in the graduate MBA degree will be required to submit GMAT verbal and written scores as well as IELTS or TOEFL scores. Applicants with computer based TOEFL scores between 200 - 220 or 5.0 - 6.5 on IELTS will be required to enroll into courses that will improve and develop their academic English language skills.

Depending on their level of English proficiency, students will be registered into one or both of the following options:

- Courses in the summer Intensive English Program, or
- EAP courses in the fall semester.

If you would like more information about the EAP program, or if you would like to know if you will be



required to take EAP courses, send an email with your questions and IELTS or TOEFL scores to esl@oswego.edu.

About SUNY - Oswego

At SUNY Oswego, we foster liberal and professional learning in a dynamic, interactive and supportive environment. SUNY Oswego offers an opportunity for students to pursue unlimited horizons. With a student body of 8,500 learners, we are large enough to offer more than 100 programs of study yet small enough for students to form quality relationships with each other and caring faculty.



School of Business

Our learner-centered approach stresses quality education and experience inside and outside the classroom on our scenic, 690-acre lakeside campus. Students pursue bright futures through programs in our College of Arts and Sciences, School of Business, and School of Education – as well as innovative interdisciplinary programs that cross traditional boundaries. Oswego opens a front door on the future with internships and study abroad opportunities that consistently rate among the highest in the SUNY system.



Accredited by AACSB International



Penfield Library



The Lake Effect Café



Use Laptops in the Café



Johnson Hall First Year Residence Hall



Hart Hall Global Living and Learning Center

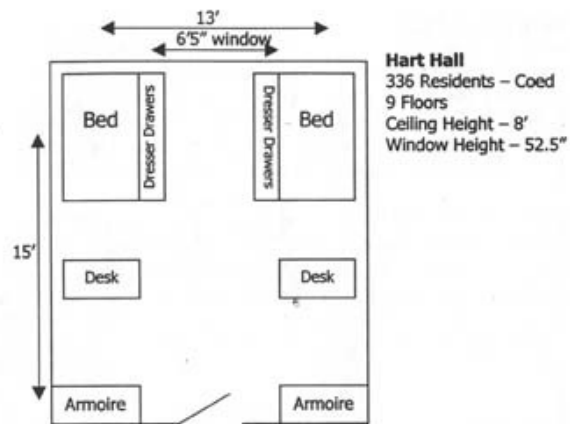

Hart Hall Floor Plan